

LEGEND

	PROPERTY LINE
	RIGHT-OF-WAY LINE
	EDGE OF CONCRETE
	EXISTING FENCE
	EXISTING MAJOR CONTOUR
	EXISTING MINOR CONTOUR
	EXISTING CURB AND GUTTER
	PROPOSED CURB & GUTTER
	EXISTING PAINT STRIPE
	PROPOSED PAINT STRIPE
	EXISTING UNDERGROUND CABLE TV LINE
	EXISTING UNDERGROUND SYRINGA COMM LINE
	EXISTING GAS LINE
	PROPOSED GAS LINE
	EXISTING OVERHEAD POWER LINE
	EXISTING UNDERGROUND POWER LINE
	PROPOSED UNDERGROUND POWER LINE
	EXISTING STORM DRAIN LINE & SIZE
	PROPOSED STORM DRAIN LINE
	EXISTING SEWER LINE & SIZE
	PROPOSED SEWER LINE & SIZE
	EXISTING WATER LINE & SIZE
	PROPOSED WATER LINE & SIZE
	EXISTING POWER POLE
	EXISTING WATER VALVE
	EXISTING FIRE HYDRANT
	EXISTING WATER METER
	EXISTING SIGN
	EXISTING SEWER MANHOLE
	EXISTING LIGHT POLE
	EXISTING TREE
	EXISTING ASPHALT
	PROPOSED ASPHALT
	EXISTING CONCRETE
	PROPOSED CONCRETE

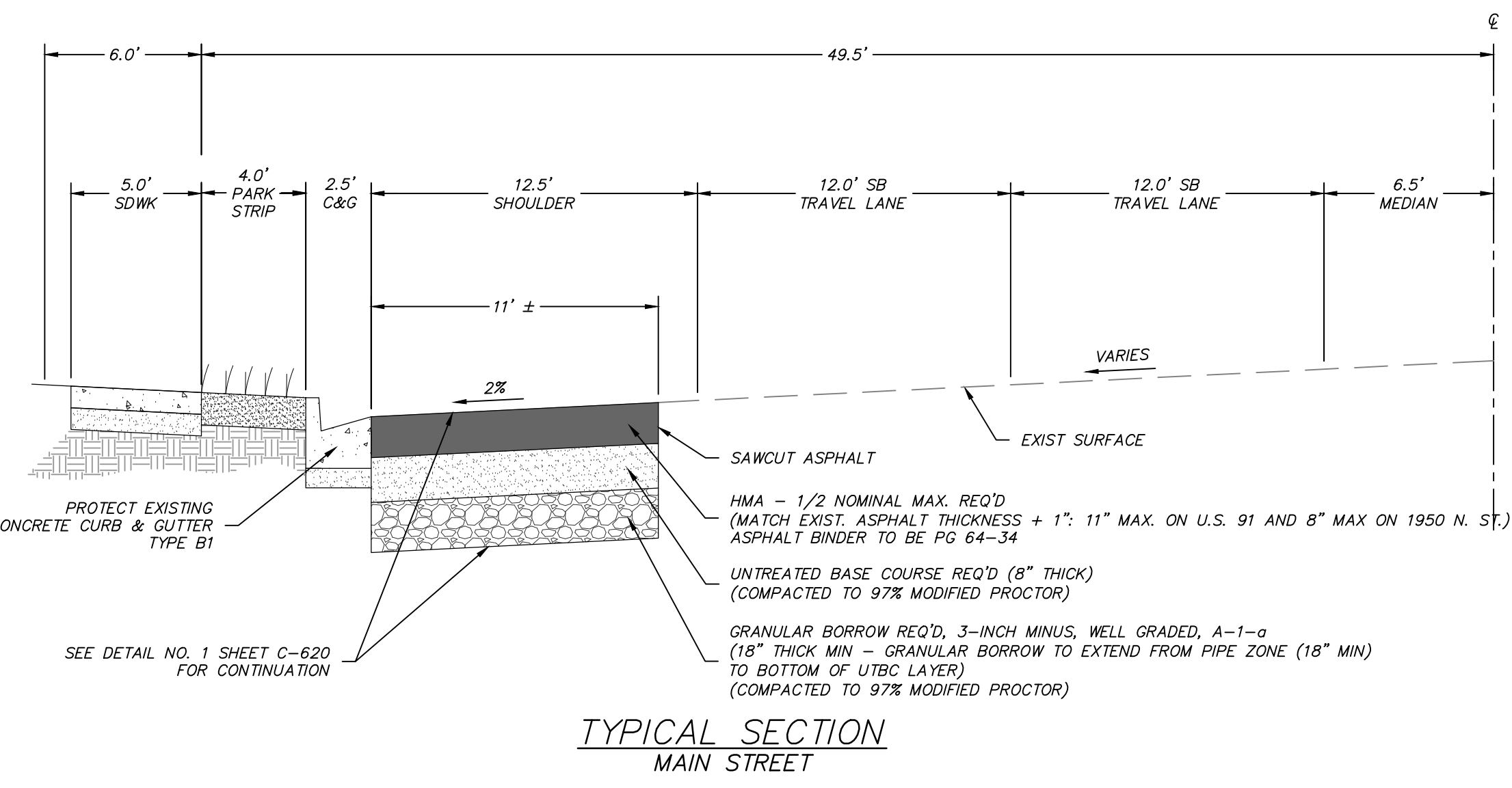

- OVERALL SITE LAYOUT KEYED NOTES:**
- PROJECT LIMIT LINE
 - SAWCUT & MATCH EXISTING ASPHALT
 - CONSTRUCT ASPHALT PAVEMENT PER UDOT STANDARDS, SEE GENERAL NOTE NO. 9
 - PROTECT OR REPLACE TYPE B1 CURB & GUTTER PER UDOT STANDARD DRAWING NO. GW 2
 - PROTECT EXISTING STORM DRAIN MANHOLE
 - PROTECT EXISTING 2' X 1' CONCRETE BOX CULVERT
 - CONNECT TO 8" WATER MAIN AT MAIN STREET AT EXISTING 8" GATE VALVE (MJ X MJ).
 - NOT USED
 - INSTALL 8" C-900 DR-14 WATER MAIN
 - INSTALL 45° BEND AND INSTALL JOINT RESTRAINTS PER UTILITY PLAN DETAIL.
 - EXISTING STORM DRAIN BOX - PROTECT IN PLACE
 - EXISTING GAS MAIN - PROTECT IN PLACE
 - EXISTING POWER POLE - PROTECT IN PLACE
 - EXISTING SEWER MANHOLE - PROTECT IN PLACE
 - EXISTING COMMUNICATIONS LINES - PROTECT IN PLACE
 - EXISTING NORTH LOGAN CITY SANITARY SEWER PIPELINE - PROTECT IN PLACE
 - REPLACE PAINT STRIPING (4" SOLID WHITE LINE).
 - CONSTRUCT ASPHALT PAVEMENT WITHIN 1950 NORTH ST. PER LOGAN CITY STANDARDS
 - CONNECT TO 10" AT 1950 N. ST. REMOVE 90° FITTING. INSTALL 10"x10"x8" TEE FITTING. INSTALL 8"x10" REDUCER. INSTALL 8" RSOV.
 - EXISTING 10" WATER MAIN - PROTECT IN PLACE.
 - EXISTING 8" WATER MAIN - PROTECT IN PLACE.
 - EXISTING FIRE HYDRANT - REMOVE ASSEMBLY, VALVE, AND TEE. SALVAGE HYDRANT TO PROJECT.
 - EXISTING WATER METER - PROTECT IN PLACE.
 - INSTALL HYDRANT ASSEMBLY PER APWA STANDARD PLAN NO. 543 AS AMENDED BY LOGAN CITY. REUSE EXISTING HYDRANT.
 - RESTRAIN ALL JOINTS DOWNSTREAM OF VALVES. SEE DEAD END (8") RESTRAINED LENGTH, DETAIL NO. 2 SHEET C-620.
 - CONSTRUCT THRUST BLOCK. PROVIDE MIN. OF 11.3 SQ. FT. THRUST BLOCK AREA AND 0.84 CU. YD. CONCRETE.

- GENERAL NOTES:**
- ALL CONSTRUCTION WITHIN THE UDOT RIGHT-OF-WAY SHALL CONFORM TO THE MOST CURRENT UDOT STANDARD (INCLUDING SUPPLEMENTAL) DRAWINGS AND SPECIFICATIONS, FOUND AT UDOT.UTAH.GOV/GO/2012STANDARDS.
 - COORDINATE WITH UDOT PROJECT 13738 TO ENSURE ALL PAVEMENT CUTS AND WORK WITHIN THE UDOT RIGHT-OF-WAY ARE COMPLETED PRIOR TO THE BEGINNING OF, AND NOT IN CONFLICT WITH THE PLANS OF THE LISTED UDOT PROJECT. PROJECT IS SCHEDULED FOR THE SUMMER OF 2017. CONTACT PROJECT MANAGER DANIEL YOUNG AT 801-419-7023 FOR MORE INFORMATION.
 - ALL WATER AND SEWER IMPROVEMENTS TO BE PER LOGAN CITY STANDARDS AND SPECIFICATIONS EVEN WHEN WITHIN UDOT'S RIGHT OF WAY. ONCE OUT OF THE PIPE BEDDING ZONE, TRENCH BACKFILL SHALL BE PER UDOT STANDARDS.
 - IT IS THE CONTRACTORS RESPONSIBILITY TO OBTAIN ALL REQUIRED PERMITS FROM UDOT AND LOGAN CITY PRIOR TO CONSTRUCTION.
 - ANY DAMAGED SIDEWALK, CURB AND GUTTER, OR PEDESTRIAN RAMPS DUE TO PERMIT WORK TO BE REPLACED AT NO COST TO UDOT. SEE UDOT STANDARD DRAWINGS GW SERIES FOR INSTALLATION REQUIREMENTS THAT MATCH EXISTING FEATURES. REMOVE ALL CONCRETE SIDEWALK, CURB AND GUTTER TO NEAREST EXISTING JOINT.
 - THE ASPHALT SECTION IN THE UDOT RIGHT-OF-WAY IS TO BE: 8" HMA, 8" UTBC AND 18" GRANULAR BORROW, OR MATCH EXISTING (WHICHEVER IS GREATER). UDOT-APPROVED HOT MIX ASPHALT (HMA), PG-GRADE 64-34 ASPHALT BINDER, 1/2" NOMINAL MAX. 7-75-115 GYRATION PER UDOT STANDARD SPECIFICATION 02741; UNTREATED BASE COURSE PER UDOT SPECIFICATION 02721; GRANULAR BORROW PER UDOT SPECIFICATION 02056
 - EXISTING POWER & COMMUNICATIONS TO BE RELOCATED AND REMOVED AS NEEDED. CONTRACTOR TO COORDINATE WITH APPROPRIATE UTILITY COMPANIES.
 - GENERAL CONTRACTOR TO COORDINATE ALL UTILITY WORK WITH THE APPROPRIATE UTILITY PROVIDER. GENERAL CONTRACTOR TO VERIFY AND FOLLOW ALL UTILITY PROVIDER REQUIREMENTS, PROCEDURES, STANDARDS, AND SPECIFICATIONS.
 - SUBMIT AS-BUILT SURVEYED CAD LINES OR SHAPEFILES FOR ALL UTILITIES PLACED, EXPOSED, OR DETECTED BY SUE METHODS. SUBMIT THE GEOREFERENCED FILE(S) TO THE REGION 1 GIS MANAGER (DAVE ALGER) AT DALGER@UTAH.GOV.
 - ALL FINAL SAWCUT LINES OR ROTOMILLING MUST BE LOCATED EITHER AT DESIGNED LANE LINES OR DESIGNED CENTER OF LANE. SAWCUTS MUST BE CLEANED AND A TACK-COAT APPLIED BEFORE ASPHALT PLACEMENT.
 - UTILITY TRENCH PATCHES REQUIRE ROTOMILLING OF A DISTANCE OF AT LEAST 20 FT APPROACHING AND LEAVING THE PATCH IN ALL TRAVEL LANES IMPACTED BEFORE FINAL ASPHALT PLACEMENT.
 - ALL WATER LINES TO HAVE A MINIMUM COVER OF 5-FEET.

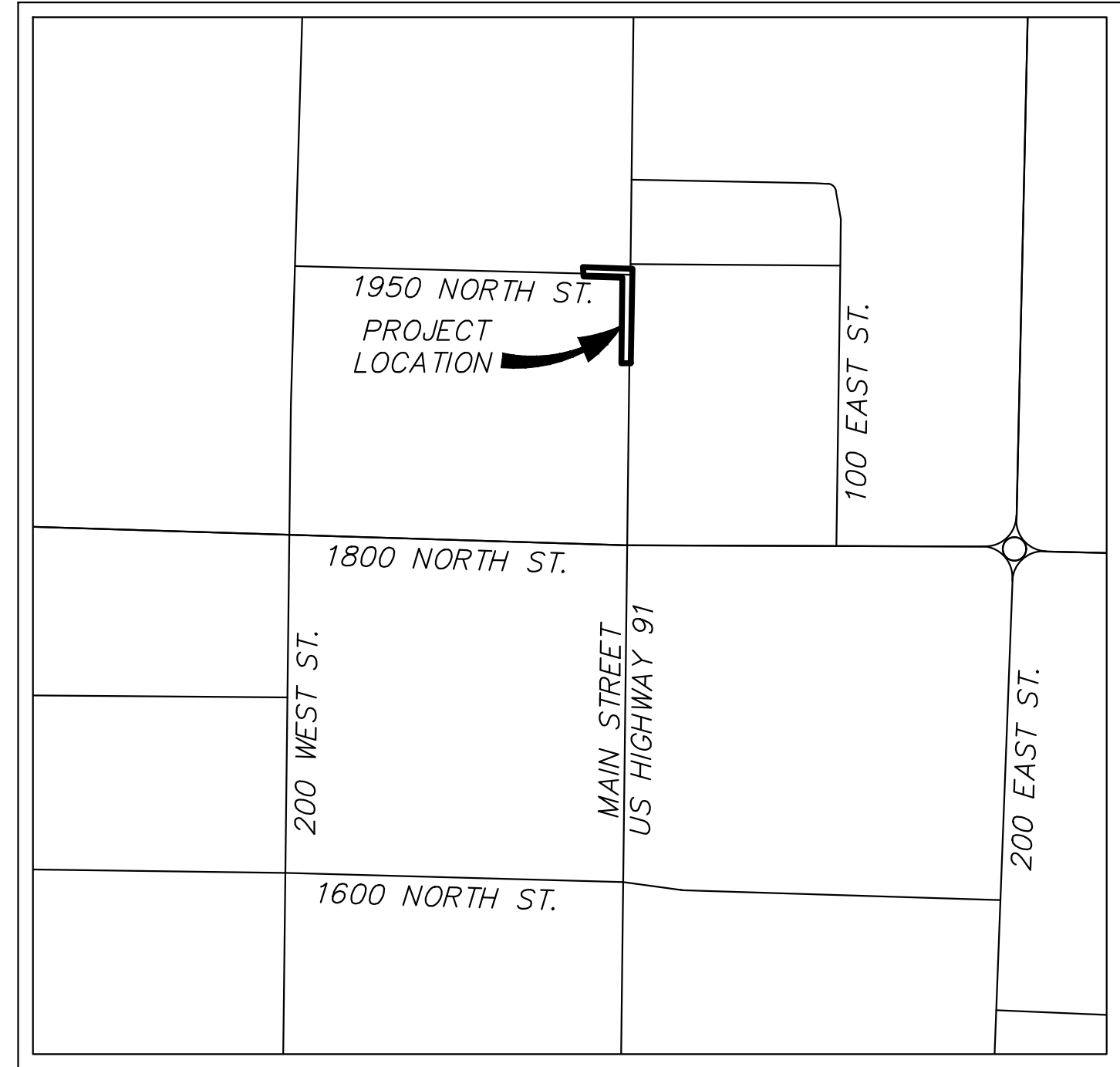

VICINITY MAP
NOT TO SCALE

PLOTTED March 21, 2018 BY Richard Borek FILE 213015 PROJECTS\150600HON\7A YOUNG.HONMA - LOGAN\ROAD CONSTRUCTION DOCUMENTS\C-610 150600HON UDOT SITE PLAN.DWG

DESCRIPTION									
NO.	DATE								
1950 NORTH MAIN WATERLINE EXTENSION (ENG18014)									
LOGAN CITY 290 N. 100 W. LOGAN, UT 84321									
Engineers Surveyors Planners									
95 Golf Course Rd. Suite 101 Logan, UT 84321 435.713.0099									
DATE: 21 MARCH 2018									
SCALE: 1" = 20'									
DESIGN BY: C. REINERT									
CHECKED BY: S. EARL									
APPROVED BY: S. EARL									
PROJECT NUMBER: 15060HON									
SHEET:									
C-610									

